

# 600mm True Handleless Double Oven unit - Medium - Left Hand Hinge

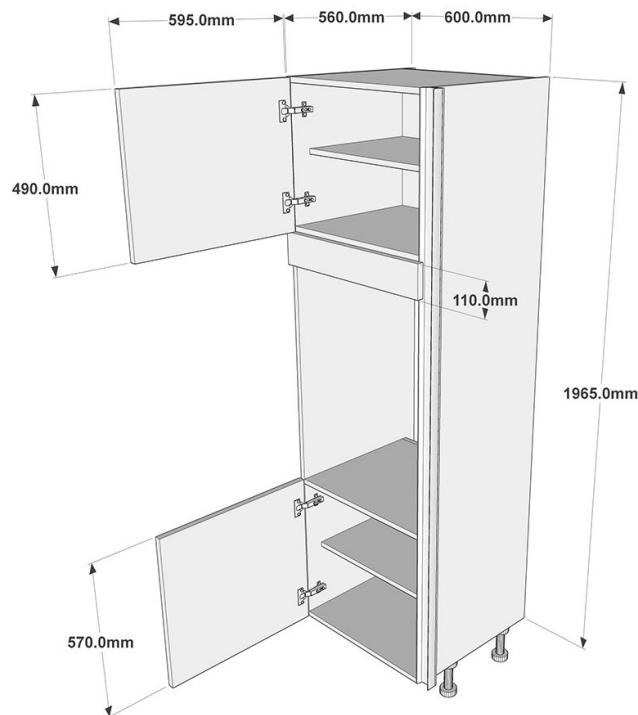

## Information

Medium height True Handleless double oven housing unit supplied with a 570 x 596mm door and a 490 x 596mm door in your chosen style and colour. A 110 x 596 Filler Panel is also supplied. Legs and Soft Close Hinges are included. True Handleless Rail System sold separately.

## Cabinet Specification

- 18mm thick colour matched cabinet (where possible).
- 47mm Service Void.
- 150mm Plastic Legs (adjustable from 140-160mm).
- Soft Close Hinges.
- True Handleless Rail System sold separately.

## Fitting Instructions

Insert the 150mm Leg piece (found in plastic fittings bag supplied) into each of the sockets on the base of the cabinet. Level the unit as required and securely fix any adjacent units using the Cabinet Connectors and to the wall using the supplied 'L' Brackets and appropriate screws (not supplied).

## Special Notes

The 110mm Filler Panel is to be cut down on site after the appliance has been fitted to suit. This Carcase is designed to accept the True Handleless Rail System.