

125mm Wine Base Unit

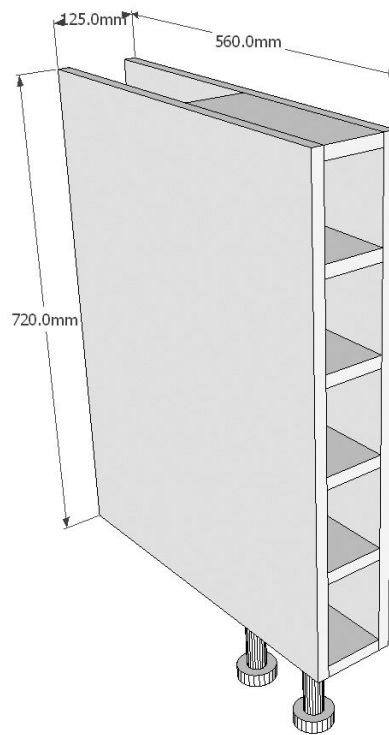

Information

Wine rack base unit in your chosen carcass colour. Legs are included.

Cabinet Specification

18mm thick colour matched cabinet (where possible).

47mm Service Void.

150mm Plastic Legs (adjustable from 140-160mm).

Fitting Instructions

Insert the 150mm Leg piece (found in plastic fittings bag supplied) into each of the sockets on the base of the cabinet. Level the unit as required and securely fix any adjacent units using the Cabinet Connectors and to the wall using the supplied 'L' Brackets and appropriate screws (not supplied).

Special Notes

Note that this unit is supplied in your chosen carcass colour and is not made of the door material.