

# 900mm Drawerline Sink Base Unit

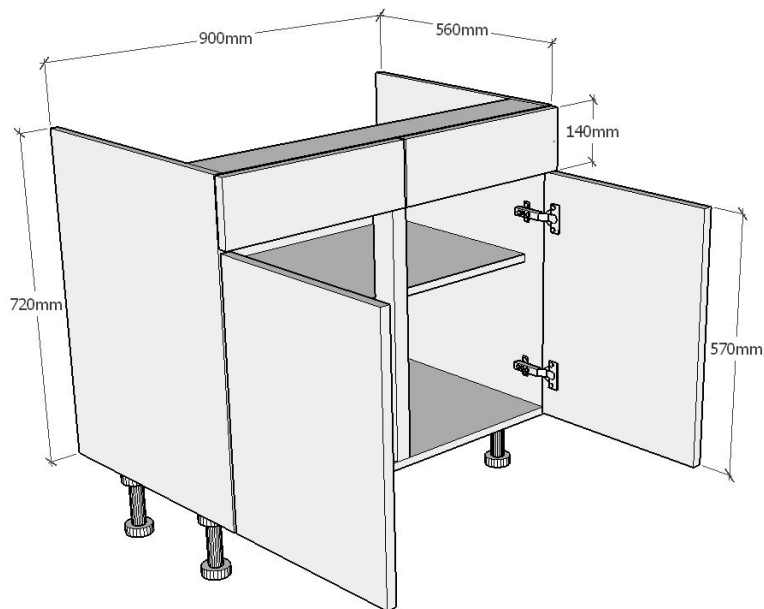

## Information

Drawerline sink base unit supplied with two 570 x 446mm doors and two 140 x 446mm fixed drawer fronts in your chosen style and colour. Legs and Soft Close Hinges included.

## Cabinet Specification

18mm thick colour matched cabinet (where possible).

47mm Service Void.

150mm Plastic Legs (adjustable from 140-160mm).

Soft Close Hinges.

## Fitting Instructions

Insert the 150mm Leg piece (found in plastic fittings bag supplied) into each of the sockets on the base of the cabinet. Level the unit as required and securely fix any adjacent units using the Cabinet Connectors and to the wall using the supplied 'L' Brackets and appropriate screws (not supplied).

## Special Notes

This unit has a lower back panel to allow for pipework while fitting your sink.

Because this unit is for use with a sink, the Drawer panels on this unit are fixed to the carcass and are not functioning drawers.