

# 900mm Drawerline Base Unit

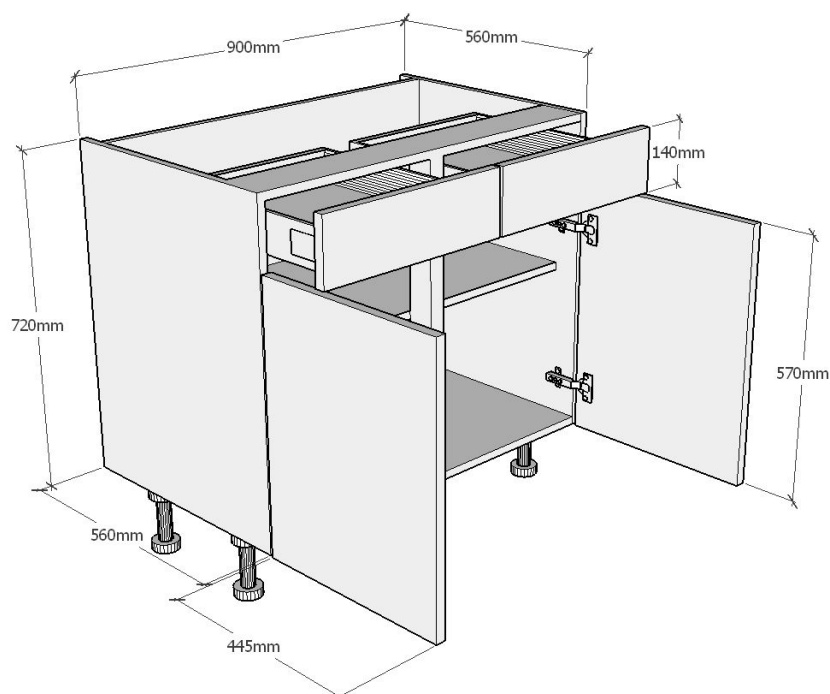

## Information

Standard double drawerline base unit supplied with two 570 x 446mm door and two 140 x 446mm drawer fronts in your chosen style and colour. Soft close drawer fittings , Legs and Hinges included.

## Cabinet Specification

18mm thick colour matched cabinet (where possible).

47mm Service Void.

150mm Plastic Legs (adjustable from 140-160mm).

Soft Close Hinges.

Soft Close Drawer Fittings.

## Fitting Instructions

Insert the 150mm Leg piece (found in plastic fittings bag supplied) into each of the sockets on the base of the cabinet. Level the unit as required and securely fix any adjacent units using the Cabinet Connectors and to the wall using the supplied 'L' Brackets and appropriate screws (not supplied).

## Special Notes

None.